

Ballot Box - 1/2 m x 1/2m - Line Drawing

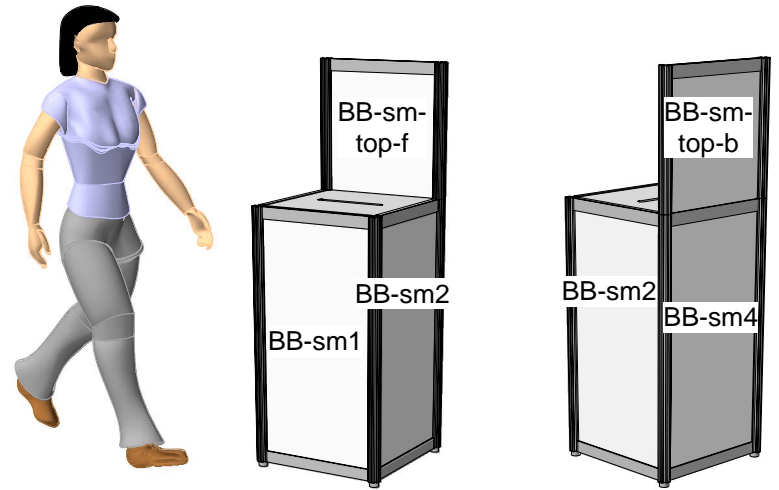

	Name Ballot Box - halfm x halfm		
	Reference Reference		
	Drawn By MM	Revision r3	Date 7/7/2016

Ballot Box - 1/2 m x 1/2m - Agam List, Graphic Dimensions

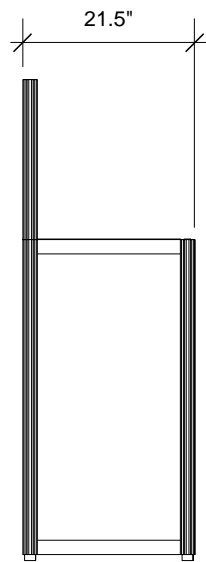
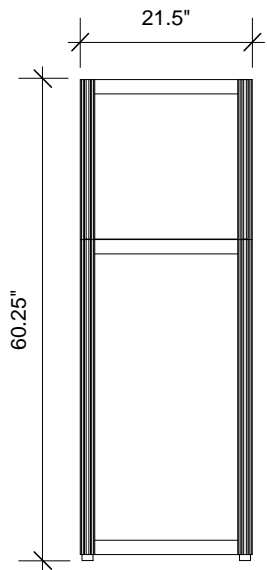
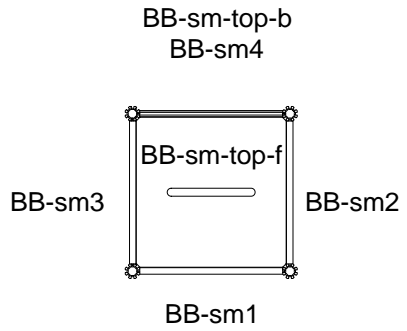
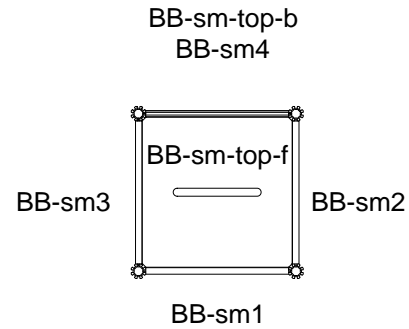
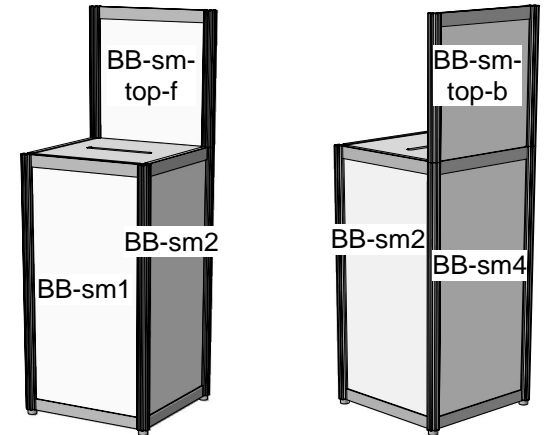
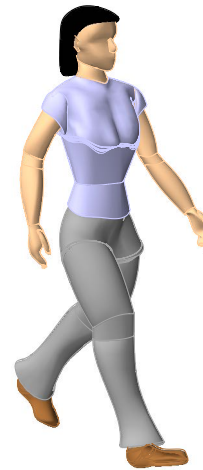

Agam List-Pub Bin, Half m x Half m				
Extrusion Type	Length	Chord Length	Radius	Qty
SP 10	17.875	0	0	4
PX8000 Connector	8	0	0	2
PX8000 Cap	0	0	0	4
PX 8000	39.375	0	0	4
PX 8000	20	0	0	2
PH 1005	17.875	0	0	9
Leveler	0	0	0	4

Panel List					
Panel #	Width	Height	Qty	Material	Graphic Sides
BB-sm-top	18.5	18.75	1	PVC	2
BB-sm	18.5	36.25	4	PVC	4

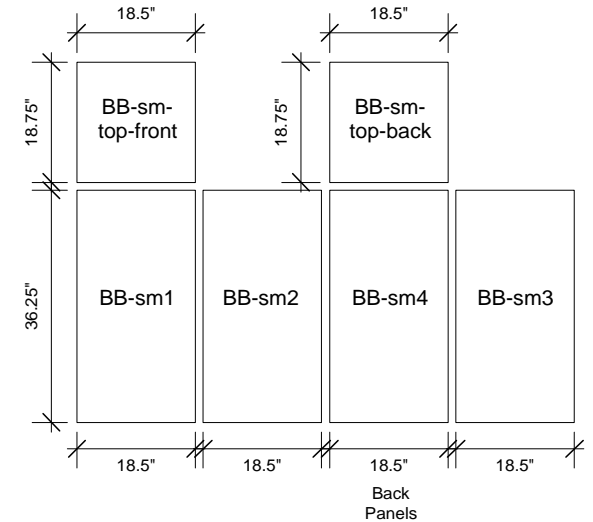
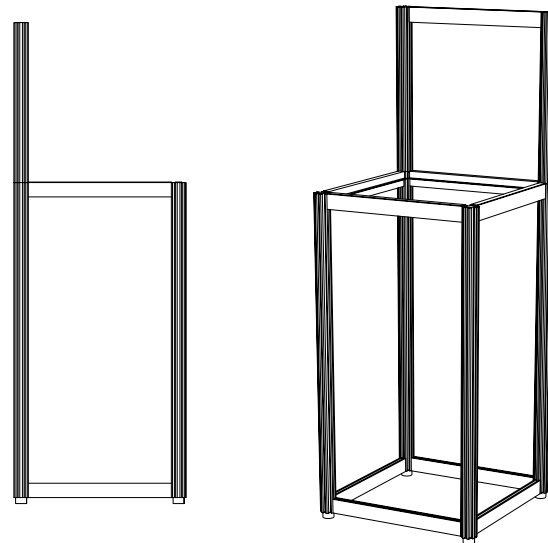
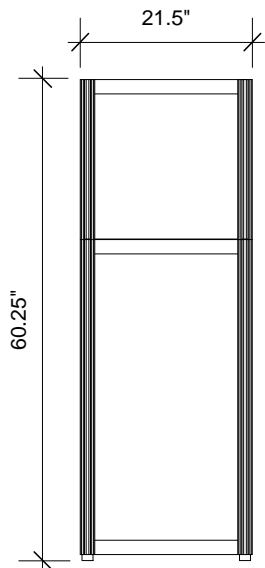

	Name Ballot Box - halfm x halfm		
	Reference Reference		
Drawn By MM	Revision r3	Date 7/7/2016	